

周边利害关系人:

近日我局接到市房屋征收中心向我局报来金台区龙丰村改造项目安置区、伟宝粤旧城改造项目安置区总平面图...

面积为5.746亩;代征防护绿地用地面积为7.727亩;代征城市道路面积为22.775亩。商业用地总建筑面积为4.82万平方米...

经审查,该项目总平面规划方案满足现行规范及管理要求。为提高社会公众参与及监督城市规划管理工作的积极性...

联系电话:3260255

宝鸡市自然资源和规划局 2022年9月9日



规划公示

图例: 规划用地范围, 围墙, 建筑退界线, 地库范围线, 新建建筑, 原有建筑, RD-侧石线, RD-红线, 出入口, 建筑层数, 小区路网, 建筑高度, 装饰地面, 车库入口, 公共厕所, 垃圾收集点, 绿地, 消防登高场, 地面停车区, 非机动车停车区, 分期界线, 道路中心线

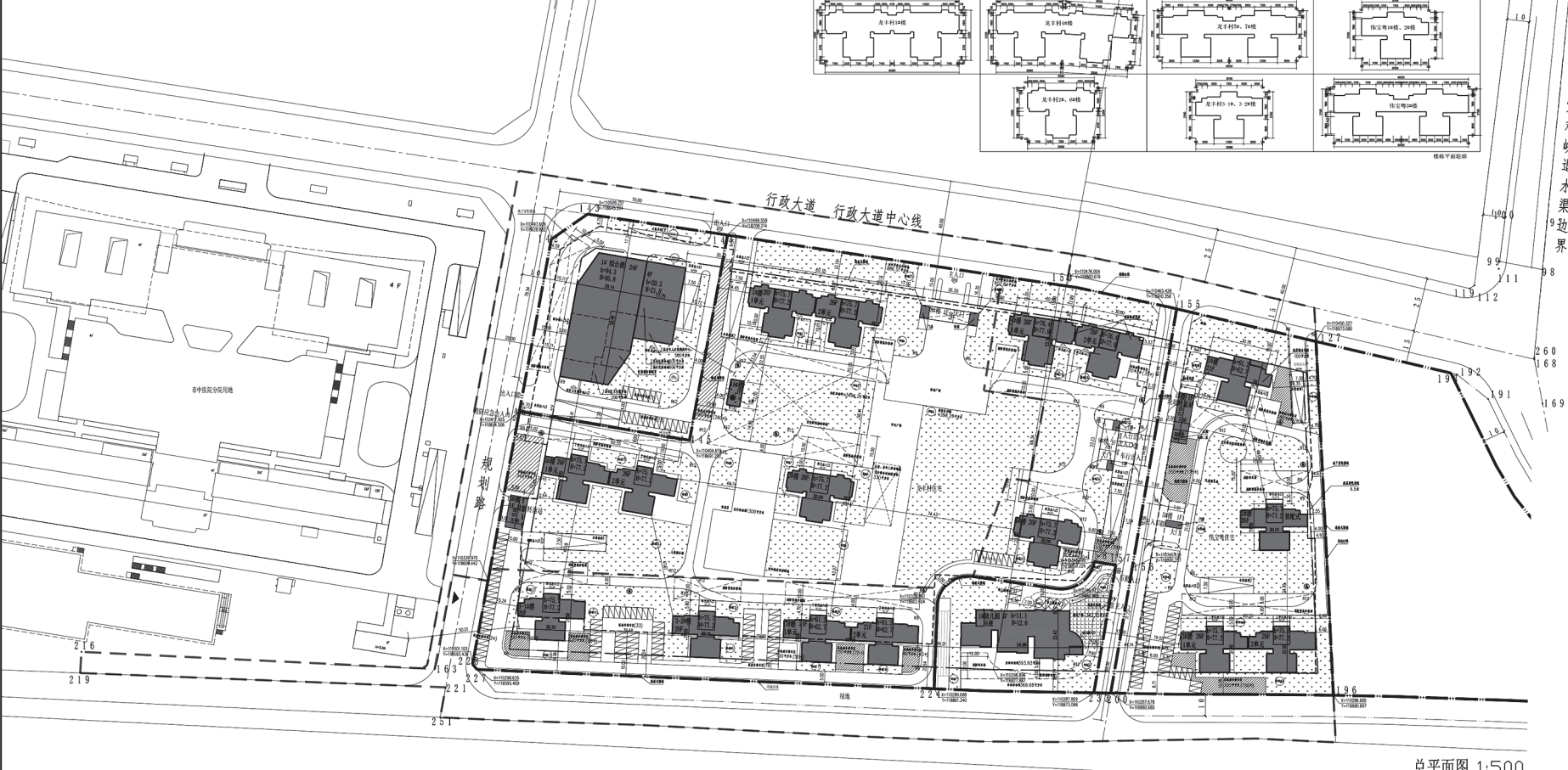

本图不签章无效

龙丰村、伟宝粤住宅经济技术指标:

Table with 4 columns: Category, Unit, Value, Remarks. Includes metrics like 规划用地面积, 总建筑面积, 建筑密度, 容积率, 居住户数, etc.

龙丰村建筑面积明细表:

Table with 6 columns: Building No., Name, Floors, Base Area, Standard Floor Area, Building Area, Non-counting Area. Lists buildings 1# through 14# and their respective areas.

龙丰村住宅经济技术指标:

Table with 4 columns: Category, Unit, Value, Remarks. Includes metrics like 规划用地面积, 总建筑面积, 容积率, 居住户数, etc.

商业地块经济技术指标:

Table with 4 columns: Category, Unit, Value, Remarks. Includes metrics like 规划用地面积, 总建筑面积, 建筑密度, 容积率, 停车位, etc.

幼儿园建筑面积明细表:

Table with 5 columns: Building No., Name, Floors, Base Area, Standard Floor Area, Building Area, Roof Area. Lists building 1# (幼儿园).

幼儿园经济技术指标:

Table with 4 columns: Category, Unit, Value, Remarks. Includes metrics like 规划用地面积, 总建筑面积, 容积率, 居住户数, etc.

伟宝粤住宅经济技术指标:

Table with 4 columns: Category, Unit, Value, Remarks. Includes metrics like 规划用地面积, 总建筑面积, 容积率, 居住户数, etc.

伟宝粤建筑面积明细表:

Table with 6 columns: Building No., Name, Floors, Base Area, Standard Floor Area, Building Area, Non-counting Area. Lists buildings 1# through 7# and their respective areas.

说明:

1. 本图依据甲方提供的相关设计数据及市政相关资料绘制而成。2. 本图坐标与城市测量坐标系统一致,高程采用黄海高程系统...

鼎正建筑设计有限公司 DINGZHENG ARCHITECTURAL DESIGN CO.,LTD. 设计证书编号 A261149209. Includes company logo and contact information.

设计编号: DESIGN CONTRACT NO. 建设单位: 宝鸡市人民政府房屋征收中心. Includes project details and professional seals.

伟宝粤住宅经济技术指标:

Table with 4 columns: Category, Unit, Value, Remarks. Includes metrics like 规划用地面积, 总建筑面积, 容积率, 居住户数, etc.

伟宝粤建筑面积明细表:

Table with 6 columns: Building No., Name, Floors, Base Area, Standard Floor Area, Building Area, Non-counting Area. Lists buildings 1# through 5# and their respective areas.

设计编号: DESIGN CONTRACT NO. 建设单位: 宝鸡市金台区龙丰村、伟宝粤安置房建设项目. Includes project details and professional seals.